

PERMIT - REAR DECK WITH ROOFED DECK ADDITION
E, SNELLVILLE, GA

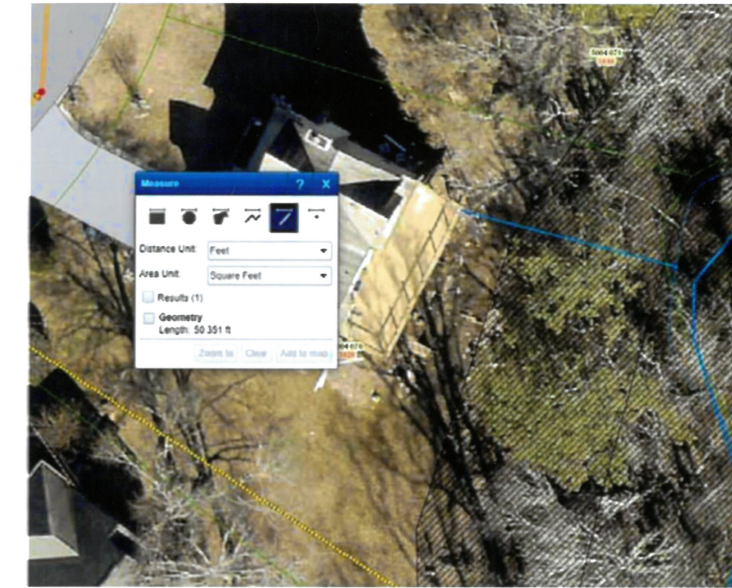

encroachment into the 50-foot stream buffer and 25-foot impervious surface survey prepared and sealed by a Georgia registered land surveyor, easements, floodplain, 50-foot stream buffer and 75-foot setback from top of stream bank). Provide calculation of the total area of the stream buffer and/or impervious surface setback.

The City will determine if a variance(s) from the Stream Buffer Ordinance is required, so, the type of variance(s) required, as the ordinance gives the authority for the Board of Appeals approval is required.

